

DF Revolution

Rotary Type Fully Automatic
Glasswashing Machine



SPECIFIER STATEMENT

Specified unit will be Moyer Diebel model DF Revolution Rotary Type, fully automatic glasswasher. Unit shall include integrated controller complete with LCD display providing system status and Operator feedback, automatic fill, clean, self flushing rinse chamber, draining features with a multi speed conveyor for adjustable wash settings, touchless conveyor shut-off, automated system diagnostics and AI water quality monitoring. Additional standard features include 24" wide cabinet, electric tank heater, removable and cleanable upper and lower wash/rinse arms, polypropylene conveyor, splash curtain, double wall construction detergent, rinse and sanitizing pumps with capacity to store three 1-gallon containers.

STANDARD FEATURES

- **Integrated Tank & Wash Chamber** – Operator-centric design for easy access during daily use.
- **Auto Fill, Clean, & Drain** – Requires no operator action.
- **AI Water Quality Monitoring** – Refreshes wash water as needed during operation without interruption.
- **Revolutionary EZ-Clip Wash & Rinse Arms** – Design for easy removal and cleaning.
- **38% Less Water Consumption** – Industry-leading water savings.
- **Compact 24" Wide Design**
- **Smart Controls** – On board machine diagnostics.
- **2" LCD Screen** – For intuitive operation.
- **Multi Speed System(low/med/high)** – Direct drive conveyor motor with anti-jam, and adjustable speed control to produce premium results for all soil conditions for all glassware.
- **Touchless Conveyor Shut-Off** – Advanced sensor technology reduces risk of damage to delicate glassware.
- **Self-Flushing Rinse Chamber** – Reduces cleaning requirements during operation due to channeling water to reduce soil build up.
- **Solid State Sensors** – No mechanical switches and no adjustments required.

BEST-IN-CLASS CORE FEATURES

- **12" Glass Clearance** – Fits taller stemware.
- **Double-Walled Construction** – For quiet operation.
- **Cool Final Rinse** – Glasses are ready for immediate use.
- **Polypropylene Conveyor** – Prevents chipping of delicate glassware.
- **Smart LED Lights** – Customizable lighting for operator conditions and integrated notifications.

OPTIONAL PREMIUM FEATURES

- **Integrated Chemical Monitoring** – Optimal results for washing and sanitizing (factory installed only).

OPTIONS & ACCESSORIES

- ☐ Drain tray and waste collector (DFWC) P/N 0715145
- ☐ Quick disconnect package (incl. casters) P/N 0707258
- ☐ Casters; set of four (2 locking, 2 regular) P/N 0701962
- ☐ Bar Mat (Size 23 5/8" x 17") P/N 0515155

Dimensions shown in inches and [millimeters]

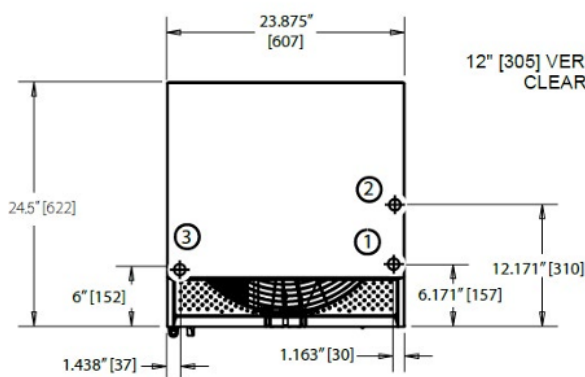

Plan View

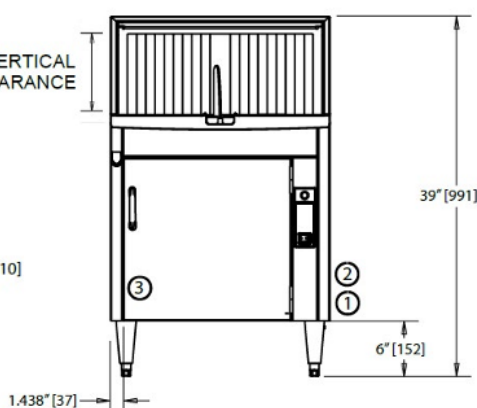

Front View

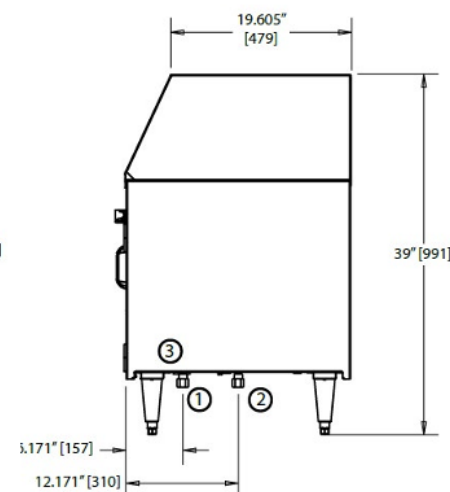

Side View

Utilities

1	Electrical Connection 230/60/1, 15 amp breaker
2	Hot Water Connection 1/2" [13] IPS. Flow pressure 25-95 psi [172.5-656 kPa]
3	Cold Water Connection 1/2" [13] IPS. Flow pressure 25-95 psi [172.5-656 kPa]
4	Drain Connection 1-1/2" [38] tailpiece. Connect to drain size according to local plumbing code.

	Uncrated	Crated
Height	39" [991]	46-1/2" [1181]
Width	23-7/8" [607]	27" [685]
Depth	24-1/2" [622]	27-1/2" [698]
Ship Wt. lbs/kg	156/71	176/80

* Adjustable foot height - 11/4" [45]

*Note: DF Models supplied with 6 ft. [1829] plug in cord. (NEMA 6-15P)

SPECIFICATIONS

Capacity (hr.)

2-1/2" [64] glasses 1200

Water Consumption

Cold water (approx.) 1.6 US gpm;
6.06 l/m;
Hot water (initial fill) 3 US gallons;
11.35 liters;
2.4 imp gallons
Max use (approx.) 45.42 liters/h
12 US gph

Temperatures °F/C

Inlet water (hot) 140-160°F/61-69°C
Inlet water (cold) 75°F/24°C

Heating

Tank heat, electric 3kW

Conveyor Movement

Clockwise

Warning: Plumbing and electrical connections should be made by qualified personnel who will observe all the applicable plumbing, sanitary and safety codes.

Plumbing Notes: Because of the variation in house-supplied steam and water pressures, steam and water pressure regulating valves (PRVs) may be needed. (Water PRV is standard on machines with booster.) The PRVs can either be purchased from Champion or obtained locally.

Champion does not endorse using on-demand (tankless) water heating systems, as well as PEX and other plumbing materials that may limit water flow, as these could impair machine performance. For optimal results, we recommend using appropriately sized conventional hot water tanks and standard copper water supply lines that adhere to our specifications. Not following these recommendations may void the manufacturer's warranty.

Water hardness of 3 grains/US Gal (0.83 Imp Gal) - 5.3 Mg/L or less

Moyer Diebel – USA
3765 Champion Blvd., NC 27105
336-661-1979 • Fax: 336-661-1979

www.moyerdiebel.com

Due to an ongoing value analysis program at Moyer Diebel, specifications contained in this catalog are subject to change without notice.