

201HT

Undercounter High Temperature
Dishwashing Machine
with Built-in Booster Heater



SPECIFIER STATEMENT

Specified unit will be Moyer Diebel Model 201HT undercounter high temperature dishwashing machine with built-in booster.

Features include 15-3/4" door opening, standard detergent and rinse-aid dispensing pumps. Built-in 70°F rise booster, and wash tank heater maintains water required temperature.

1 year parts and labor warranty.

Vent hood is not recommended as unit does not produce excessive steam. Always follow local building code guidelines.



STANDARD FEATURES

- **Multi-Power** allows for infield conversion to 208-240 volt and/or single to three phase
- **Soft Start** to protect glasses and dishes from chipping and breaking
- **Rinse Sentry** extends the rinse cycle to ensure 180°F final rinse
- **Built-in Booster** 180°F final rinse (standard 6kW 70°F rise or optional 9kW high speed recovery booster)
- **Scrub Feature** extends wash cycle for heavily soiled wares
- **Delime Feature** extends cycle up to 20 min for cleaning unit
- Pumped drain permits use of the drain connection up to 6' of which 3' can be vertical
- 25 racks per hour*
- Advance digital temperature monitoring
- Fresh water wash and pumped rinse
- Built-in detergent and rinse-aid pumps
- Advance service diagnostics
- Upper and lower interchangeable spray arms
- Stainless steel top and side panels
- Counter balance door
- Wash tank heater
- Two 20" x 20" racks, one peg and one flat
- One year parts and labor warranty

* Excludes 20 second NSF load/unload time

OPTIONS & ACCESSORIES

- | | |
|--|-------------|
| <input type="checkbox"/> 9kW high speed recovery booster | – |
| <input type="checkbox"/> Flat bottom dishrack | P/N 101273 |
| <input type="checkbox"/> Peg dishrack | P/N 101285 |
| <input type="checkbox"/> 6" Stand | P/N 0712393 |
| <input type="checkbox"/> 1" roller casters | P/N 0712480 |
| <input type="checkbox"/> 17RS – 17" Stand | P/N 0708757 |
| <input type="checkbox"/> Drain Water Tempering Kit | P/N 0708757 |
| <input type="checkbox"/> Low Chemical Alarm | P/N 0712314 |

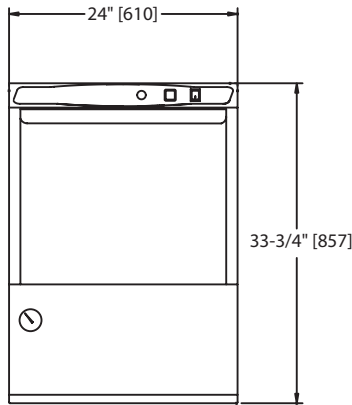

Front View

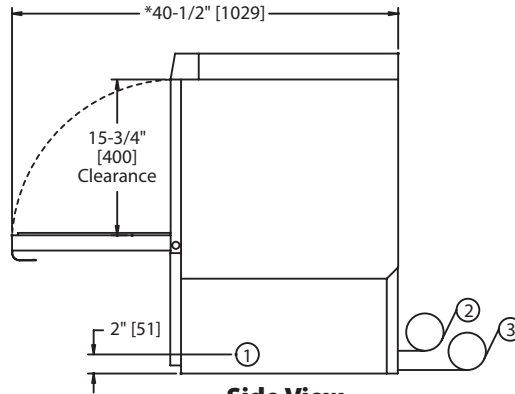

Side View

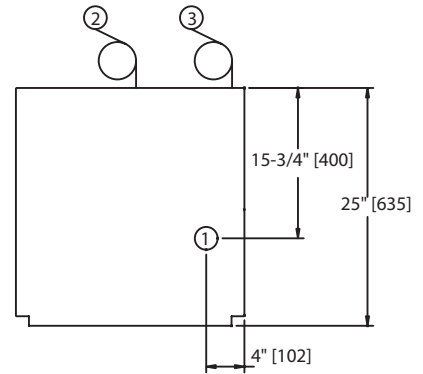

Plan View

*Note: Allow additional 3" clearance from wall.

Utilities

- 1 Electrical Connection**
208-240/60/1; 3 wire plus ground, (See Box).
208-240/60/3; 4 wire plus ground, (See Box).
- 2 Hot Water**
110°F/43°C Min., hot water for 70°F/39°C rise booster.
5 ft. long 1/2" I.D. flexible fill hose with 3/4" hose connector.
Flow pressure: 25-95 psi (173-656 kPa)
- 3 Drain Connection**
5/8" [15.9] I.D. flexible reinforced hose, 6 ft. [1829] long. Max. drain flow 15 US gpm.
[12.5 imp gal] Max. drain height 3 ft. [914]

201HT with 70°F Rise Booster

| Electrical Specs. | Rated Amps | Minimum Supply Ckt. Conductor Ampacity | Maximum Overcurrent Protective Device |
|-------------------|------------|--|---------------------------------------|
| 208/60/1 | 32 | 40 | 40 |
| 240/60/1 | 36 | 40 | 40 |
| 208/60/3 | 22 | 30 | 30 |
| 240/60/3 | 24 | 30 | 30 |

201HT with 9 kW High Speed Recovery Booster

| Electrical Specs. | Rated Amps | Minimum Supply Ckt. Conductor Ampacity | Maximum Overcurrent Protective Device |
|-------------------|------------|--|---------------------------------------|
| 208/60/1 | 45 | 60 | 60 |
| 240/60/1 | 50 | 60 | 60 |
| 208/60/3 | 29 | 35 | 35 |
| 240/60/3 | 33 | 40 | 40 |

| | Uncrated | Crated |
|---------------------------|----------|---------|
| Height | 33-3/4" | 39-1/2" |
| Width | 24" | 25" |
| Depth | 25" | 25-1/2" |
| Ship Wt. lbs/kg | 178 | 198 |

* Adjustable foot height - 11/4" [45]

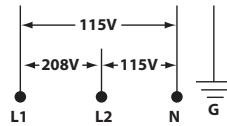

*Note: Electrical supply service must be a 3-wire plus ground for connection as shown.

Note: Field convertible to accept 3 phase power.

SPECIFICATIONS

Capacity

*Racks per hr. 25

Motor Horsepower

Wash 1

Water Consumption

Per hr. (max. use) 38.4 US gal;
Per rack 1.8 US gal;

Temperatures °F

Wash (minimum) 150
Rinse (minimum) 180

Heating

Tank heat, electric (kW) 2.0
Electric booster
(kW required for 70°F rise) 6
(kW required for high speed recovery) 9

Time Cycle in Seconds

Wash 90
Rinse 26
Drain/fill 25
Total 141

* Excludes 20 second NSF load/unload time

Warning: Plumbing and electrical connections should be made by qualified personnel who will observe all the applicable plumbing, sanitary and safety codes.

Plumbing Notes: Because of the variation in house-supplied steam and water pressures, steam and water pressure regulating valves (PRVs) may be needed. (Water PRV is standard on machines with booster.) The PRVs can either be purchased from Champion or obtained locally.

Champion does not endorse using on-demand (tankless) water heating systems, as well as PEX and other plumbing materials that may limit water flow, as these could impair machine performance. For optimal results, we recommend using appropriately sized conventional hot water tanks and standard copper water supply lines that adhere to our specifications. Not following these recommendations may void the manufacturer's warranty.

Water hardness of 3 grains/US Gal (0.83 Imp Gal) - 5.3 Mg/L or less

Moyer Diebel – USA
3765 Champion Blvd., NC 27105
336-661-1979 • Fax: 336-661-1979

www.moyerdiebel.com

Due to an ongoing value analysis program at Moyer Diebel, specifications contained in this catalog are subject to change without notice.