

## 601HRG

Undercounter Heat Recovery  
Glasswasher with Built-in Booster



### SPECIFIER STATEMENT

Specified unit will be the Moyer Diebel model 601HRG undercounter heat recovery glasswasher at 29-5/8" standard height with built-in booster operating on a 1/2" cold water supply only.

Features include a 7-1/4" height stand, 12-1/8" door opening, selectable 120,200 and 277 second cycle times, built-in 5kW booster, 2 kW tank heater, LED temperature display, Rinse Sentry, rinse aid and detergent pumps, flexible fill and drain hoses as well as an auto-clean cycle which flushes tank interior at shutdown. Unit shall incorporate a RAPID DRY feature to improve and quicken the drying of wares. Wash tank constructed of type 316 stainless steel.

1 year parts and labor warranty.

Vent hood is not recommended as unit does not produce excessive steam. Always follow local building code guidelines.



### STANDARD FEATURES

- **Heat recovery: Cold water feed only!**
- **Up to 50% more energy efficient!**
- **Quicker drying of wares!**
- **Condensation is removed!**
- **Reduced operation costs!**
- **RAPID-DRY** provides improved and quicker drying of glassware
- **Ergonomical, practical**, 22-1/2" [572] loading height
- **Soft Start**, protects glasses and mugs from chipping and breaking
- **Industry leading**, deep drawn, type 316 stainless steel tank
- **12-1/8" [308] door opening**, ideal for racked glasses
- **Multi-cycle**; 3 cycle time options for enhanced cleaning
- Delime feature allows easy deliming of wash cavity
- Auto-clean flushes tank interior at end of serving period
- Electric tank heater (2 kW)
- Microcomputer controls and digital temperature displays
- Standard pumped drain for total ease of installation
- Liquid detergent and rinse-aid dispensing pumps complete with prime switches

### OPTIONS & ACCESSORIES

- |  |               |
|--|---------------|
| <input type="checkbox"/> 3 Phase Connection (prewired at factory)            | –             |
| <input type="checkbox"/> Drain Water Tempering Kit                           | P/N 0713725   |
| <input type="checkbox"/> Low Chemical Alarm                                  | P/N 0712314-2 |
| <input type="checkbox"/> Power Cord Kit                                      | P/N 0713741   |
| <input type="checkbox"/> 17RS – 17" Stand<br>(replaces existing stand)       | P/N 0708757   |
| <input type="checkbox"/> 4" Stand (converts to a standard<br>counter height) | P/N 0714292   |
| <input type="checkbox"/> 1" Roller kit (adds 1" to height)                   | P/N 0712480-1 |
| <input type="checkbox"/> Flat bottom dishrack                                | P/N 101273    |
| <input type="checkbox"/> Peg dishrack  | P/N 101273    |

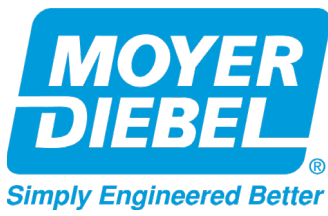

# 601HRG

Undercounter Heat Recovery  
Glasswasher with Built-in Booster

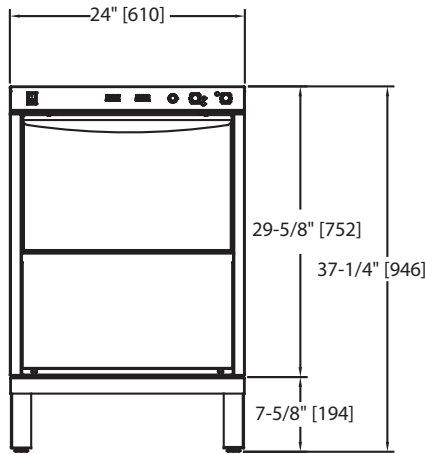

Front View

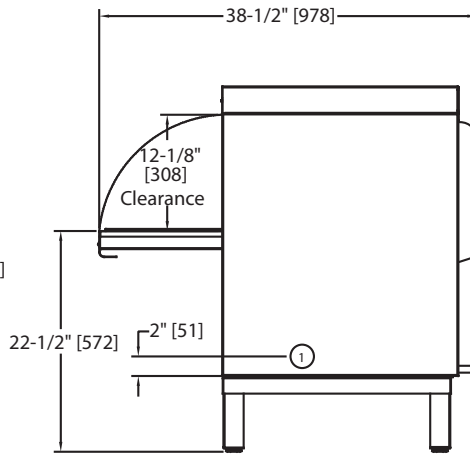

Side View

Dimensions shown in inches and [millimeters]

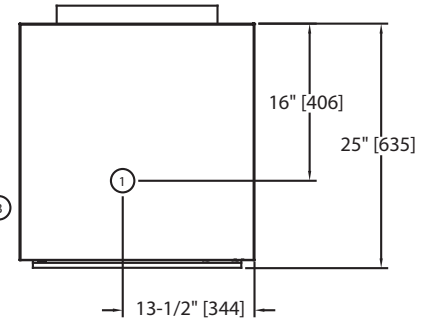

Plan View

## Utilities

- 1 Electrical Connection**  
208-240/60/1; 3 wire plus ground. (see box)  
208-240/60/3; 4 wire plus ground.  
Field convertible to accept 3 phase power, see service manual for details
- 2 Cold Water**  
1/2 supply; 55-80°F cold water; 25 PSI min.  
Machine equipped with 3/4" hose connect
- 3 Pumped Drain**  
5/8" I.D. flexible reinforced hose, 6ft. long.  
Max. drain flow 15 US gpm. Max drain height 3ft

## 601HRG with Booster

Electrical Specs.	Rated Amps	Minimum Supply Ckt. Conductor Ampacity	Maximum Overcurrent Protective Device
208/60/1	32	40	40
240/60/1	36	40	40
208/60/3	22	30	30
240/60/3	24	30	30

Field convertible to accept 3 phase power

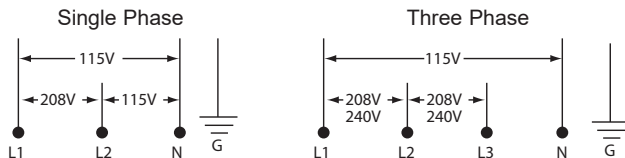

## SPECIFICATIONS

### Capacity

\*Racks per hr. 25

### Motor Horsepower

Wash 1

### Water Consumption

U.S. gal per hr (max use) 15.6  
U.S. gal per rack 0.65

### Temperatures °F

Wash (minimum) 150  
Rinse (minimum) 180

### Heating

Tank heat, electric (kW) 2  
Electric booster 5

### Time Cycle in Seconds

Wash 45/120/197  
Rinse 13  
Drain/Fill 62

### Standard 20"x20" Rack Complement

Dish 1  
Open 1

\* Excludes 30 second NSF load/unload time

**Warning:** Plumbing and electrical connections should be made by qualified personnel who will observe all the applicable plumbing, sanitary and safety codes.

**Plumbing Notes:** Because of the variation in house-supplied steam and water pressures, steam and water pressure regulating valves (PRVs) may be needed. (Water PRV is standard on machines with booster.) The PRVs can either be purchased from Champion or obtained locally.

Champion does not endorse using on-demand (tankless) water heating systems, as well as PEX and other plumbing materials that may limit water flow, as these could impair machine performance. For optimal results, we recommend using appropriately sized conventional hot water tanks and standard copper water supply lines that adhere to our specifications. Not following these recommendations may void the manufacturer's warranty.

Water hardness of 3 grains/US Gal (0.83 Imp Gal) - 5.3 Mg/L or less

Moyer Diebel - USA  
3765 Champion Blvd., NC 27105  
336-661-1979 • Fax: 336-661-1979

www.moyerdiebel.com

Due to an ongoing value analysis program at Moyer Diebel, specifications contained in this catalog are subject to change without notice.