

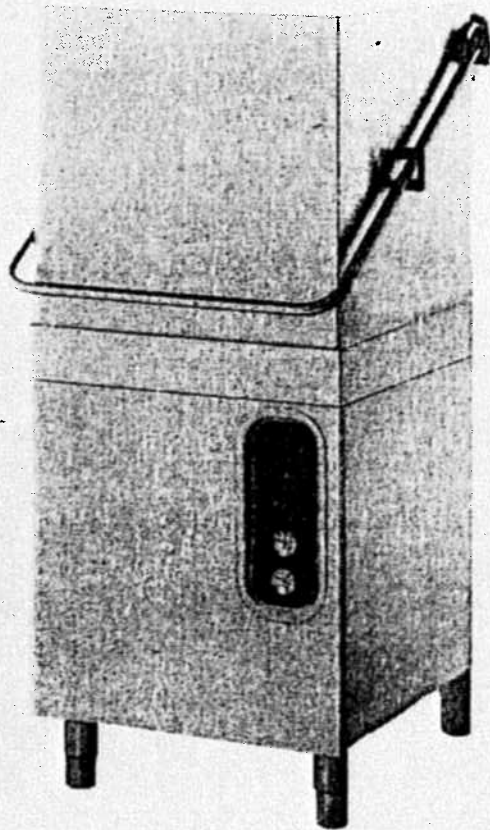

**Simply Engineered Better**

*For machines beginning with Serial No.*

## **Technical Manual**



### **Hood-Type Dishwasher**

**Model**

**MH65 M1**

High Temperature  
with Built-in Booster

**Prior to  
Machine Serial No.**

**W8100**

**October, 2001**

**Manual P/N 0509787 Rev. C**

2674 North Service Road  
Jordan Station, Ontario, Canada L0R 1S0  
905/562-4195 Fax: 905/562-4618  
800/263-5798 Email: moyerd@vaccine.com

**Moyer Diebel Ltd.**

**Complete the information below for quick reference.**

Model Number \_\_\_\_\_ Serial Number \_\_\_\_\_

Voltage and Phase \_\_\_\_\_

Champion Parts Supplier \_\_\_\_\_ Phone \_\_\_\_\_

Champion Service Agency \_\_\_\_\_ Phone \_\_\_\_\_

**Moyer Diebel (Canada)  
National Service Department**

Phone: 1(905) 562-4195

1(800) 263-5798

Fax: 1(905) 562-4618

**Note:** When calling to order parts, be sure to have the model number, serial number, voltage and phase of your machine.

Machine Data Plate with  
model & serial number  
located on the front of the  
lower panel.

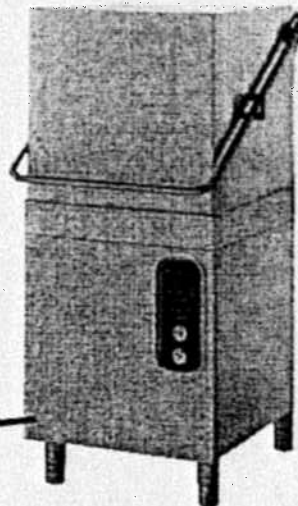

**REVISION RECORD**

<b>Revision Date</b>	<b>Revised Pages</b>	<b>Serial Number Effectivity</b>	<b>Comments</b>
5/1/99	All	—	First issue of manual and replacement parts lists
8/13/01	—	W1888	First serial number issued with extended wash
8/13/01	1, 6, 11	W1888	Added extended wash information to operations
8/13/01	23	—	Change P/N 108349 to 0508366
8/13/01	27	—	Added thermometer overlays
10/15/01	19	—	Added description for P/N C280122

## REVISION RECORD (CONT.)

## LIMITED WARRANTY

Moyer Diebel, P.O. Box 301, 2674 N. Service Road, Jordan Station, Canada, L0R 1S0, warrants machines, and parts, as set out below.

**Warranty of Machines:** Moyer Diebel warrants all new machines of its manufacture bearing the name "Moyer Diebel" and installed within the United States and Canada to be free from defects in material and workmanship for a period of one (1) year after the date of installation or fifteen (15) months after the date of shipment by Moyer Diebel, whichever occurs first. [See below for special provisions relating to glasswashers.] The warranty registration card must be returned to Moyer Diebel within ten (10) days after installation. If warranty card is not returned to Moyer Diebel within such period, the warranty will expire after one year from the date of shipment. Moyer Diebel will not assume any responsibility for extra costs for installation in any area where there are jurisdictional problems with local trades or unions.

If a defect in workmanship or material is found to exist within the warranty period, Moyer Diebel, at its election, will either repair or replace the defective machine or accept return of the machine for full credit; provided, however, as to glasswashers, Moyer Diebel's obligation with respect to labor associated with any repairs shall end (a) 120 days after shipment, or (b) 90 days after installation, whichever occurs first. In the event that Moyer Diebel elects to repair, the labor and work to be performed in connection with the warranty shall be done during regular working hours by a Moyer Diebel authorized service technician. Defective parts become the property of Moyer Diebel. Use of replacement parts not authorized by Moyer Diebel will relieve Moyer Diebel of all further liability in connection with its warranty. In no event will Moyer Diebel's warranty obligation exceed Moyer Diebel's charge for the machine. The following are not covered by Moyer Diebel's warranty:

- a. Lighting of gas pilots or burners.
- b. Cleaning of gas lines.
- c. Replacement of fuses or resetting of overload breakers.
- d. Adjustment of thermostats.
- e. Adjustment of clutches.
- f. Opening or closing of utility supply valves or switching of electrical supply current.
- g. Cleaning of valves, strainers, screens, nozzles, or spray pipes.
- h. Performance of regular maintenance and cleaning as outlined in operator's guide.
- i. Damages resulting from water conditions, accidents, alterations, improper use, abuse, tampering, improper installation, or failure to follow maintenance and operation procedures.
- j. Wear on Pulper cutter blocks, pulse vanes, and auger brush.

*Examples of the defects not covered by warranty include, but are not limited to:* (1) Damage to the exterior or interior finish as a result of the above, (2) Use with utility service other than that designated on the rating plate, (3) Improper connection to utility service, (4) Inadequate or excessive water pressure, (5) Corrosion from chemicals dispensed in excess of recommended concentrations, (6) Failure of electrical components due to connection of chemical dispensing equipment installed by others, (7) Leaks or damage resulting from such leaks caused by the installer, including those at machine table connections or by connection of chemical dispensing equipment installed by others, (8) Failure to comply with local building codes, (9) Damage caused by labor dispute.

**Warranty of Parts:** Moyer Diebel warrants all new machine parts produced or authorized by Moyer Diebel to be free from defects in material and workmanship for a period of 90 days from date of invoice. If any defect in material and workmanship is found to exist within the warranty period Moyer Diebel will replace the defective part without charge.

**DISCLAIMER OF WARRANTIES AND LIMITATIONS OF LIABILITY. MOYER DIEBEL'S WARRANTY IS ONLY TO THE EXTENT REFLECTED ABOVE. MOYER DIEBEL MAKES NO OTHER WARRANTIES, EXPRESS OR IMPLIED, INCLUDING, BUT NOT LIMITED TO, ANY WARRANTY OF MERCHANTABILITY, OR FITNESS OF PURPOSE. MOYER DIEBEL SHALL NOT BE LIABLE FOR INCIDENTAL OR CONSEQUENTIAL DAMAGES. THE REMEDIES SET OUT ABOVE ARE THE EXCLUSIVE REMEDIES FOR ANY DEFECTS FOUND TO EXIST IN MOYER DIEBEL DISHWASHING MACHINES AND MOYER DIEBEL PARTS, AND ALL OTHER REMEDIES ARE EXCLUDED, INCLUDING ANY LIABILITY FOR INCIDENTALS OR CONSEQUENTIAL DAMAGES.**

Moyer Diebel does not authorize any other person, including persons who deal in Moyer Diebel dishwashing machines, to change this warranty or create any other obligation in connection with Moyer Diebel Dishwashing Machines.

## FOREWORD

1. Read the instructions in this manual carefully. It contains important information on installation, operation, and safety.
2. Store this manual carefully for future reference.
3. After removing packing material, check for loose parts in dishracks.
4. Before switching the equipment on, make sure that the model data plate conforms to the electrical and water requirements supplied to this particular machine.
5. Installation should be carried out by qualified personnel according to the manufacturer's instructions. The installation of your machine must meet all applicable health and safety codes.
6. This equipment should be used for its intended purpose. Any other application should be considered improper and therefore dangerous.
7. Only trained personnel should operate this equipment.
8. Operators must strictly follow all hygienic requirements in the handling of clean dishware or cutlery.
9. Do not leave the machine in an environment at temperatures lower than 0°C/32°F.
10. This machine should not be washed with a direct water stream.
11. Only qualified personnel should access the control panel after disconnecting main power supply. Tag the disconnect indicating work is being performed on that circuit.
12. Noise level of the machine is less than 67dB.

The manufacturer declines any responsibility for any printing errors contained in this booklet. The manufacturer also reserves the right to make any modifications to its products that do not affect the basic characteristics thereof.

<b>TABLE OF CONTENTS</b>	<b>PAGE</b>
<i>Revision Record</i> .....	<i>i</i>
<i>Limited Warranty</i> .....	<i>iii</i>
<i>Forward</i> .....	<i>iv</i>
<hr/>	
<b>PART 1: OPERATION</b> .....	<b>1</b>
<b>PART 2: INSTALLATION AND MAINTENANCE</b> .....	<b>9</b>
<b>PART 3: REPLACEMENT PARTS</b> .....	<b>11</b>
<b>PART 4: ELECTRICAL SCHEMATICS</b> .....	<b>33</b>

**LIST OF FIGURES**

Figure 1.1 – Control Panel Detail .....	7
Figure 3.1 – Hood and Tank .....	12
Figure 3.2 – Tank .....	14
Figure 3.3 – Handle .....	16
Figure 3.4 – Wash and Rinse Piping .....	18
Figure 3.5 – Wash and Rinse Spray Arms .....	20
Figure 3.6 – Water Inlet Piping .....	22
Figure 3.7 – Pump/Motor Assembly .....	24
Figure 3.8 – Control Panel .....	26
Figure 3.9 – Control Cabinet .....	28

# OPERATION AND USE\*

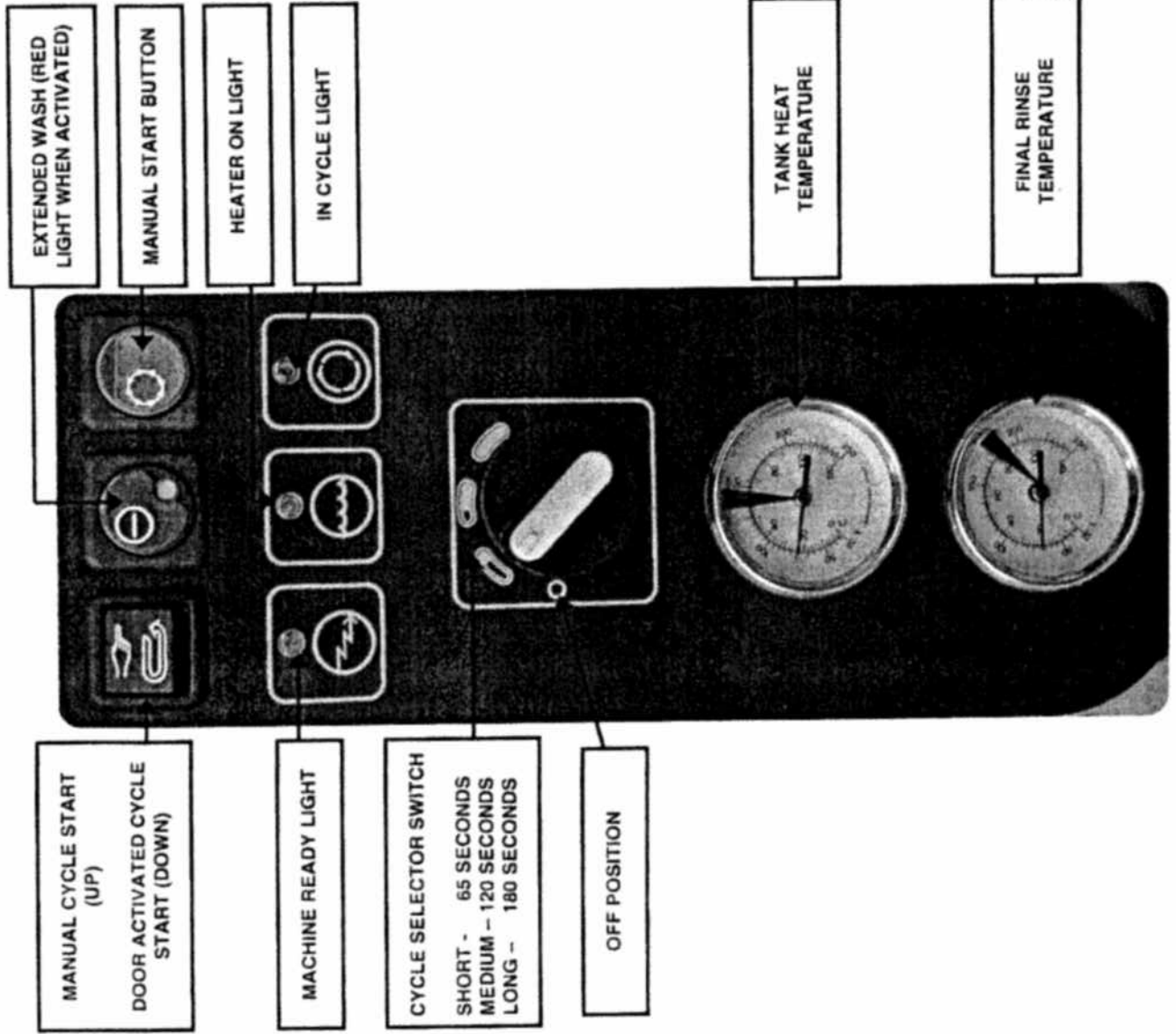

1. Close door

2. To fill, set the cycle selector switch to any position. When the automatic fill is complete, the wash tank heater light will turn on.

3. Scrap and preflush all items to be washed and load the items into the rack. Do not overload the rack. Wash cutlery upright in cutlery baskets.

4. Open the door and insert the rack into the machine.

5. With the "cycle selector switch", choose desired cycle time.

6. To start the cycle;

- For manual cycle start, flip cycle switch to the up position. Push the manual start button.
- For door-activated start, flip cycle switch to the down position. Cycle will start when the door is closed.

*Machine must be in cycle prior to activating extended wash.*

*This machine will not begin the rinse cycle until the rinse water reaches 180 ° F.*

\* FOR COMPLETE OPERATING INSTRUCTIONS PLEASE REFER TO THE TECHNICAL MANUAL PROVIDED WITH THE UNIT.



# PART 1: OPERATION

## OPERATION AND USE

1. Before washing make sure that:
  - the wall-mounted on/off switch is switched on;
  - the water tap is open and water pressure is present,
  - the pump suction filters are installed in their proper locations;
  - the overflow tube is inserted in the drain;
  - rotating spray arms move freely;
  - the rinse and detergent containers are full;
2. Set switch "A" to position 1 to enable the automatic filling of the wash tank when the wash tank has filled, lamp "B" and the wash tank heater will turn on.
3. Scrap and preflush all items to be washed and load the items into the rack. Do not overload the rack. Wash only one layer of silverware in a rack.
4. Open the door and insert the rack into the machine.
5. By means of switch "A" select the wash cycle according to conditions of the dishware:
  - with glasses or cups select the short cycle (pos.1)
  - with normally dirty dishes or cutlery select the medium cycle (pos.2)
  - with particularly dirty dishes or deep dishes select the long cycle (pos.3), or use the extended wash switch (E). This will make the dishmachine cycle in wash continuously until (E) is pressed again; the machine will then resume its normal cycle.
6. By means of selector "L", select the wash cycle for automatic start when the hood is closed, or for manual start by pressing the "M" button. Lamp "D" will switch off at the end of the cycle.



### NOTE:

*This machine will continue to wash until the booster tank thermostat shuts off; only then will the machine proceed to the rinse cycle.*

## PART 1: OPERATION (CONT.)

### OPERATION AND USE (CONT.)

7. Remove the rack at a slight incline to permit a perfect drain; allow dishware to dry. After having washed one's hands, handle the rack in order not to touch the dishware inside then place the rack on hygienically clean shelves.
8. At the end of washing, turn switch "A" to position "0", empty out the tank by taking out the overflow tube, then close the door and turn switch "A" to position "1" for a few minutes to wash inside the machine. Finally turn the switch "A" to position "0" and wait until the tank is completely empty.

For machines with drain pump, with switch "A" in position "1" and the hood open, simply push the "E" button to drain the tank.

At this point, the scrap screens can be taken out, washed, and then replaced. Make sure to reinstall the overflow tube.

For any further information concerning equipment cleaning, refer to "USEFUL SUGGESTIONS" on next page.

9. When finished washing, switch off the machine by turning off the main disconnect switch and turn off the water supply.

### INSTRUCTIONS DURING THE WASH CYCLE

1. Do not put your bare hands into the water containing detergent. If this happens, wash them immediately and thoroughly with fresh water.
2. When the machine is operating, do not open the door too quickly.
3. Use only anti-foaming detergents.
4. In the event the machine does not work properly, turn off the main power disconnect for the equipment and contact a technical service center authorized by the manufacturer for repairs.
5. Never modify the thermostat settings.
6. Check that lamp "C" is on.
7. **Wash tank water should be changed every two hours or after each meal period.**
8. Do not subject clean dishware to any further cleansing treatment such as brushes or drying towels.

If these instructions are not followed, your safety and the equipment can be compromised.

## USEFUL SUGGESTIONS

### MAINTENANCE:

#### IMPORTANT:

Before carrying out the cleaning and maintenance operations, turn off the main disconnect switch for the equipment.

Frequently check and clean the nozzles. Blocked nozzles will prevent the machine from cleaning properly.

Do not use corrosive products such as sodium hypochlorite (bleach), acids, steel wool or steel brushes to clean the inside and outside of the machine.

The presence of calcium and magnesium salt in the water can compromise machine performance. Ask a qualified chemical person to remove the deposits periodically.

Stainless steel surfaces should be well cleaned in order to avoid some oxidation risks, or chemical reactions.

### OPTIMAL RESULTS:

Poor wash results can be noted when residue remains on the dishware.

Poor results can be caused by an insufficient rinse: in this case check that the rinse nozzles are clean and that there is sufficient water supply pressure (20-22 PSI/138-151 kPa).

In case of dishware residue check that:

- the washing nozzles are clean
- the water temperature is a minimum of 60°C/140°F
- there is detergent in the container
- the pump suction filter is clean
- the racks are suitable for the dishes and cutlery that are to be washed
- the position of the cutlery and the dishes in the racks are correct

## **PART 1: OPERATION (CONT.)**

### **OPERATION AND USE (CONT.)**

#### **TEMPORARY MACHINE NON-USE**

In case the machine is stopped for a longer period of time, it is recommended to fill the tank and run the machine with clean water, then empty it. This will help prevent a bad odour from any residue remains in the pump.

If necessary repeat this operation until the water leaving the machine is clean.

If the machine is stopped for many weeks, it is recommended to oil the stainless steel surfaces with paraffin oil and **to empty the water from the booster and the wash pump.**

#### **SANITIZING THE MACHINE**

Sanitizing the machine at least once a week is of the utmost importance in order to guarantee hygiene even when the machine is not in use.

It is advisable to use a disinfecting product suggested by an authorized detergent dealer.

Before switching off the machine run the machine briefly with clean water.

#### **HARD WATER CONDITIONS**

In hard water locations, mineral deposits will form within the machine and also on dishware.

In order to avoid the above conditions delime the machine on a regular basis.

Consult your chemical supplier for directions and an appropriate deliming solution.

**This Page  
Intentionally  
Left  
Blank**

## **PART 1: OPERATION (CONT.)**

### **OPERATION AND USE (CONT.)**

Refer to Fig. 1.1 on next page.

#### **CONTROL PANEL**

- A Main switch (On/Off, Short/Medium/Long wash cycles)
- 0 Machine off
- 1 Short cycle
- 2 Medium cycle
- 3 Long cycle
- B Pilot lamp "MACHINE ON"
- C Pilot lamp "MACHINE READY"
- D Pilot lamp "MACHINE WORKING"
- E Extended wash
- G Tank thermometer
- H Booster thermometer
- L Selector manual/automatic
- M Start cycle push button

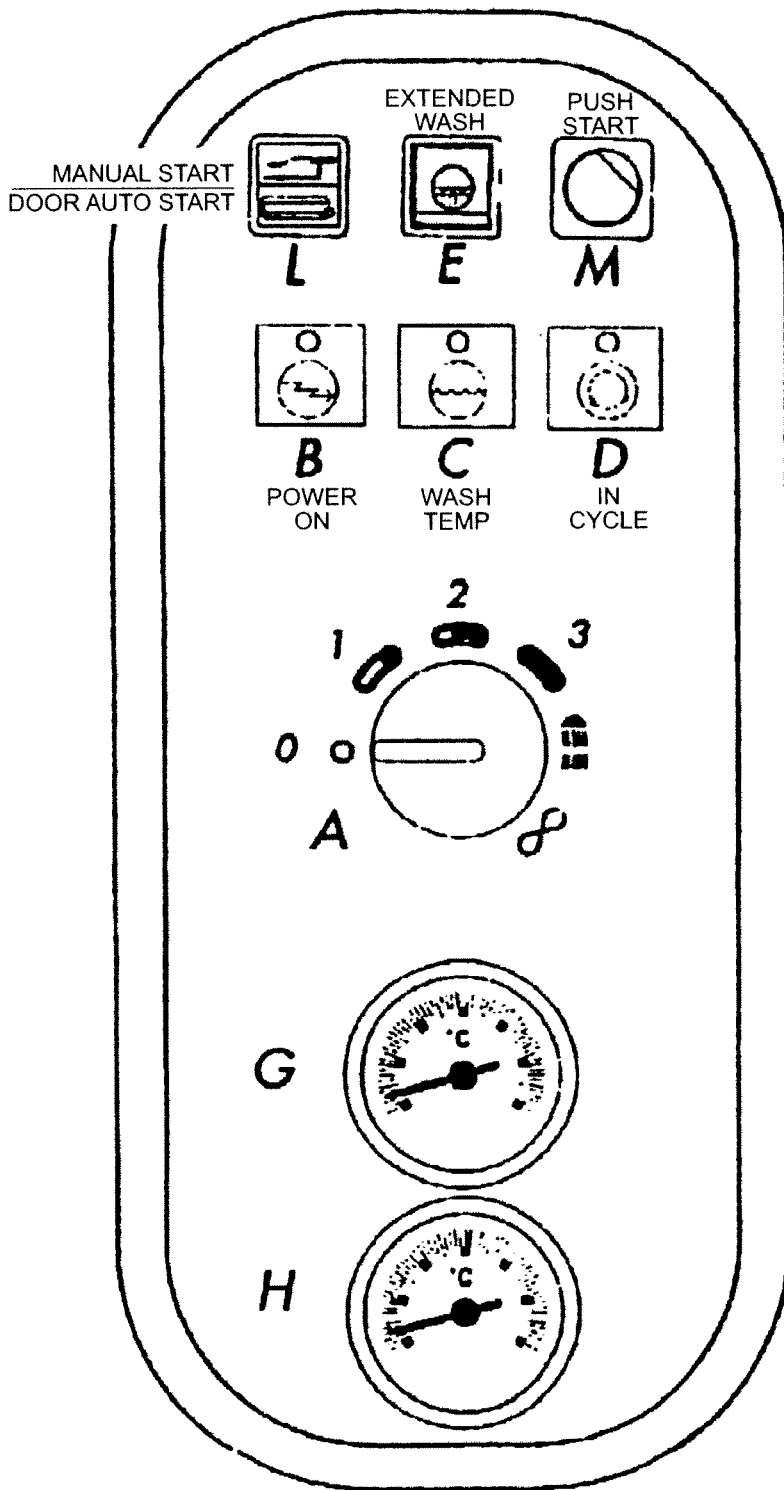

Figure 1.1-  
Control Panel Detail

**This Page  
Intentionally  
Left  
Blank**



## PART 2: INSTALLATION AND MAINTENANCE

### INSTALLATION AND MAINTENANCE INSTRUCTIONS

The following instructions are addressed to qualified personnel. Only authorized personnel are to carry out checks and repairs.

The manufacturer declines any responsibility if repairs or modifications are done by unqualified personnel or with parts not supplied by the manufacturer.

#### Installation

Level the machine by placing a level on the top of the machine and adjusting the feet. Level the machine front to back and side to side.

In order to prevent damage from steam going out of the machine, the walls surrounding the machine should be water resistant material.

After machine installation, check thermostat settings.

- Booster 180°F/82°C.
- Wash tank 150°F/68°C.

#### Electrical connections

##### **WARNING:**

Electrical and grounding connections must comply with all applicable electrical codes.

##### **WARNING:**

When working on the dishwasher, disconnect the electrical service and place a tag at the disconnect switch to indicate that work is being done on that circuit.

1. A qualified electrician must compare the electrical power supply with the machine electrical specifications before connecting to the incoming service through a fused disconnect switch.
2. A knock-out is provided at the lower right rear corner (as viewed from the front) for the electrical service connection. A fused disconnect switch or circuit breaker (supplied by others) is required to protect the power supply circuit.

#### Plumbing connections

1. The MH-65 series dishwasher requires a single hot water supply.  
Install a water shut off valve with a 3/4" NPT hose connection within 40" (1016mm) of the machine. A 6 ft. (1829mm) hose with a 3/4" NPT hose connector is supplied to connect to customers supply valve. Water temperature must be minimum 140°F/60°C at 20-22 PSI/138-151 kPa flow rate.
2. Install a 3/4" pressure reducing valve (PRV) in the water supply line if the flow pressure exceeds 20-22 PSI/138-151 kPa.

## **PART 2: INSTALLATION AND MAINTENANCE (CONT.)**

### **Drain connections**

1. The MH65 series models are gravity drain machines equipped with a 1-1/2" O.D. hose connection point.
2. The maximum drain flow rate is 15 gallons/min-56.8 litres/min.
3. Drain height must not exceed 11"(280mm) above finished floor.
4. The drain connection is made to the dishwasher from underneath the machine through an access hole in the machine base.

### **Ventilation**

#### **NOTE:**

Ventilation must comply with local sanitary and plumbing codes.

#### **CAUTION:**

Exhaust air should not be vented into a wall, ceiling, or concealed space of a building. Condensation can cause damage.

# **PART 3:**

# **REPLACEMENT PARTS**

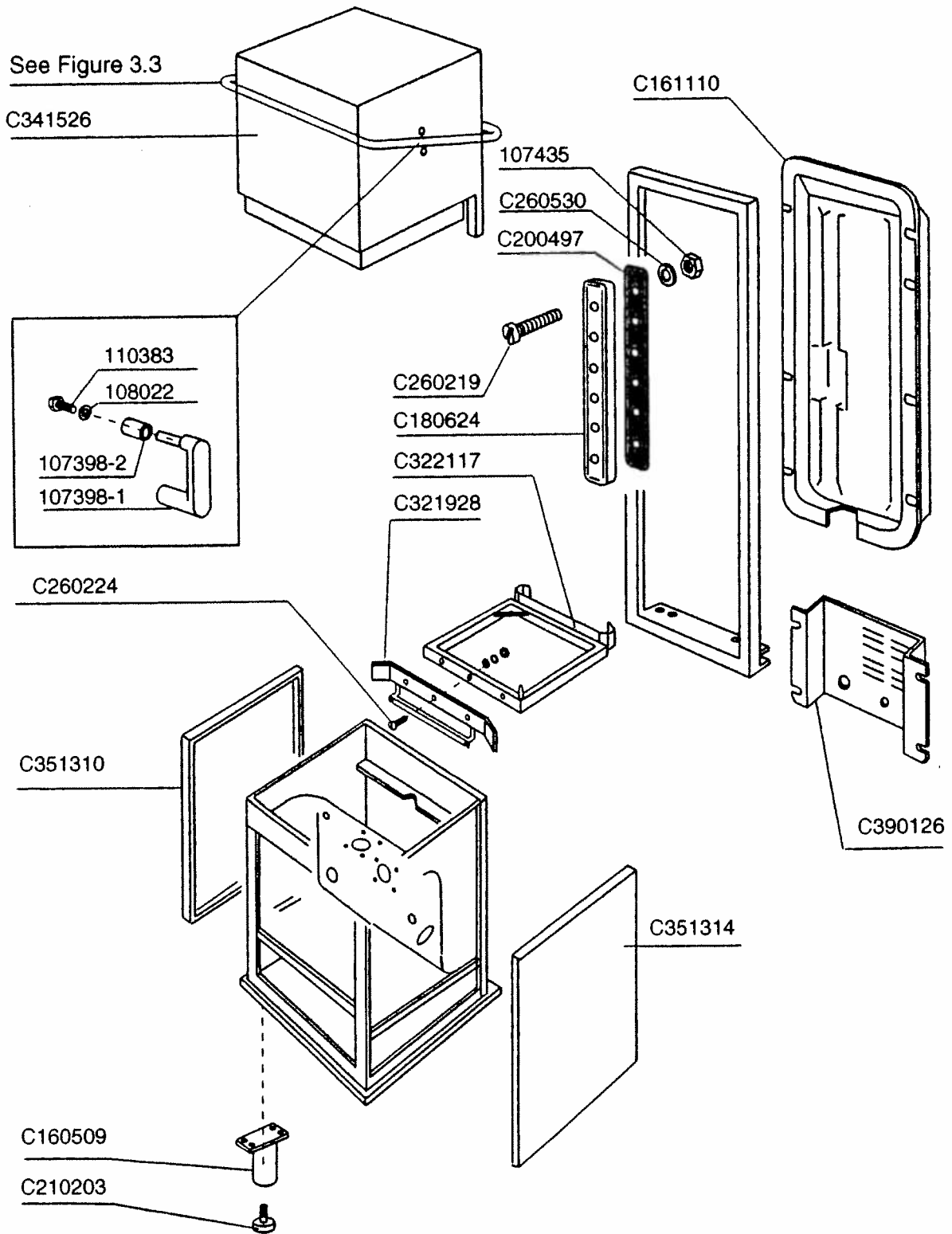

Figure 3.1- Hood and Tank

---

**HOOD AND TANK**

<b>Part No.</b>	<b>Part Description</b>
C341526	HOOD, WELDED
110383	SCREW, M8 X 12 PAN HD
108022	WASHER - WASHER, M8 PLASTIC
107398-2	DOOR LIFT BLOCK ROLLER
107398-1	DOOR LIFT BLOCK
C160509	LEG
C210203	LEG ADJUSTER
C351310	PANEL LEFT SIDE
C351314	PANEL RIGHT SIDE
C260224	SCREW, M6 X 15
C321928	GUIDE RACK
C322117	TRACK WELDED ASSEMBLY
C180624	GUIDE PLASTIC HOOD
C200497	GASKET GUIDE PLASTIC HOOD
C260219	SCREW, M6 X 30 FIL HD
C260530	WASHER -
107435	NUT, M6
C161110	PANEL BACK PLASTIC
C390126	PANEL BACK LOWER METAL

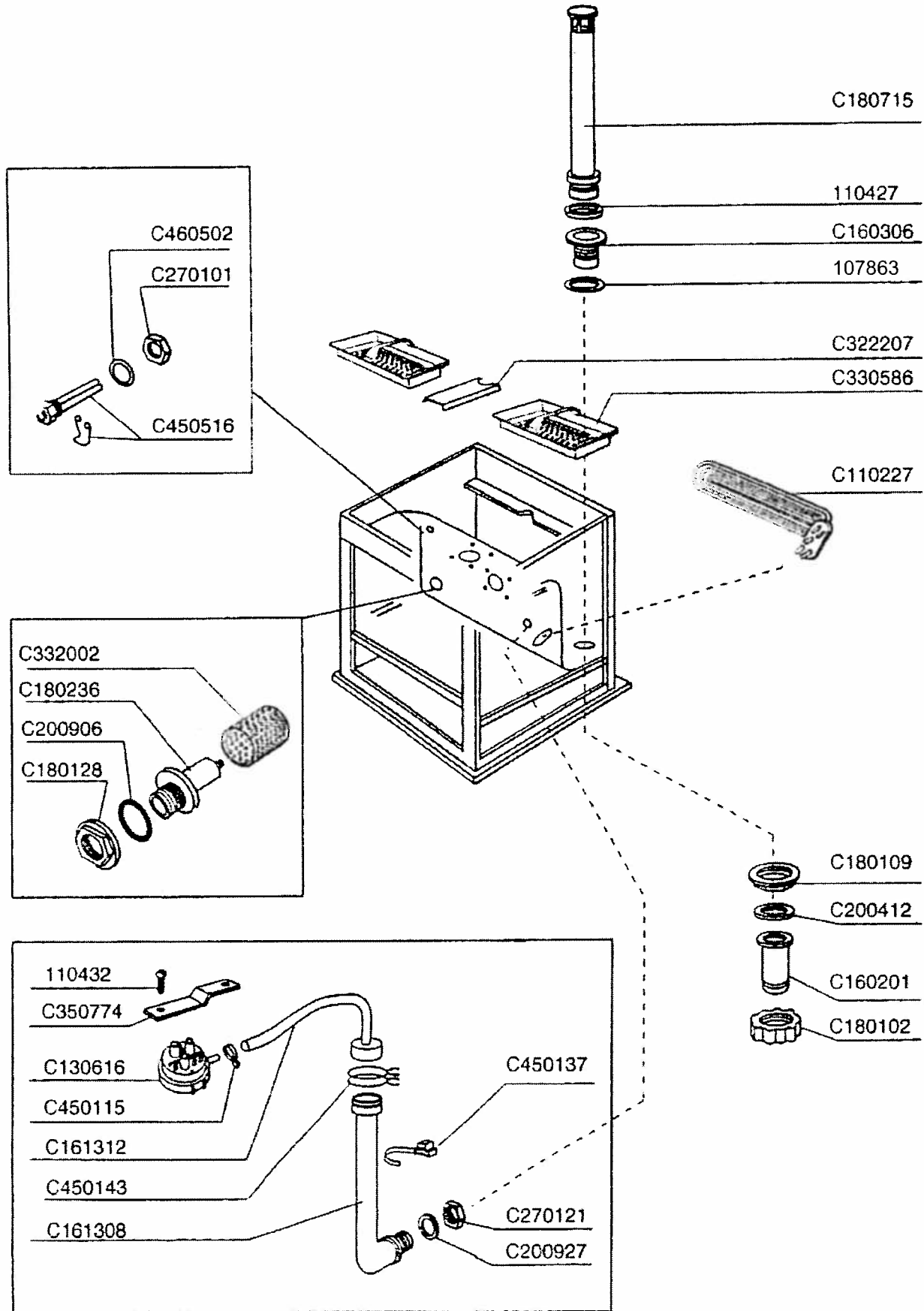

Figure 3.2- Tank

## TANK

Part No.	Part Description
C180715	TUBE OVERFLOW
110427	SEAL, OVERFLOW TUBE
C160306	FLANGE DRAIN PLASTIC
107863	GASKET DRAIN FLANGE
C180109	NUT DRAIN FLANGE
C200412	GASKET TAILPIECE
C160201	TAILPIECE
C180102	NUT TAILPIECE
C330586	SCREEN SCRAP
C322207	FILLER SCRAP SCREEN
C110227	HEATER ELEMENT WASH TANK 208-240/3PHASE
C110227	HEATER ELEMENT WASH TANK 208-240/1PHASE
C270101	NUT WASH TANK THERMAL WELL
C460502	GASKET THERMAL WELL
C450516	CLIP RETAINER WASH TANK THERMAL WELL
C332002	SCREEN PUMP SUCTION
C180236	SUPPORT SCREEN PUMP SUCTION
C200906	GASKET PUMP SUCTION SUPPORT
C180128	NUT PUMP SUCTION SUPPORT
C270121	NUT AIR TRAP
C200927	GASKET AIR TRAP
C450137	TIE PLACTIC AIR TRAP
C161308	TRAP AIR
C450143	CLAMP AIR TRAP HOSE
C161312	HOSE MOULDED AIR TRAP
C450115	CLAMP HOSE PRESSURE SWITCH
C130616	SWITCH PRESSURE
C350774	BRACKET MOUNTING PRESSURE SWITCH
110432	SCREW MOUNTING PRESSURE SWITCH

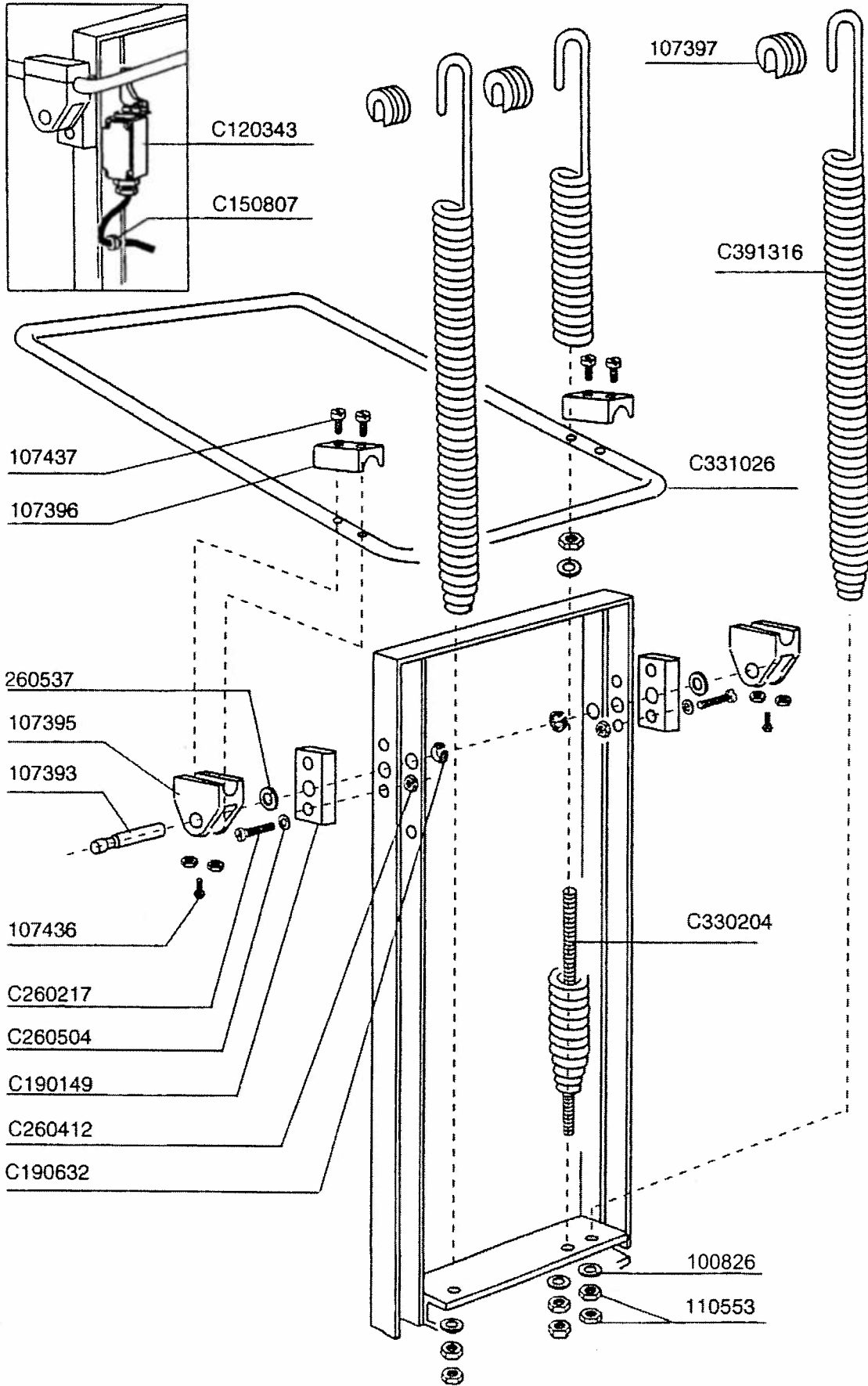

Figure 3.3- Handle



**HANDLE**

<u>Part No.</u>	<u>Part Description</u>
110553	NUT, M8
100826	WASHER, FLAT
C330204	ROD, THREADED SPRING EXTENSION
C391316	SPRING HOOD LIFT
107397	BLOCK, SPRING HOOK
C190632	BUSHING PIVOT HOOD
107435	NUT, M6
C190149	BLOCK PIVOT HOOD FRAME MOUNTED
C260504	WASHER, LOCK
C260217	SCREW, M6 X 25 FIL HD.
107436	SCREW, M6 X 16 FIL HD.
107393	PIN, PIVOT HOOD
107395	BLOCK, PIVOT LOWER
C190632	WASHER, FLAT
107396	BLOCK PIVOT TOP
107437	BOLT, M6 X 45
C331026	HANDLE, HOOD
C120343	SWITCH, HOOD ACTIVATED
C150807	GROMMET
C260537	PIVOT SPACER
C260412	NUT, 6mm C/W NYLON INSERT

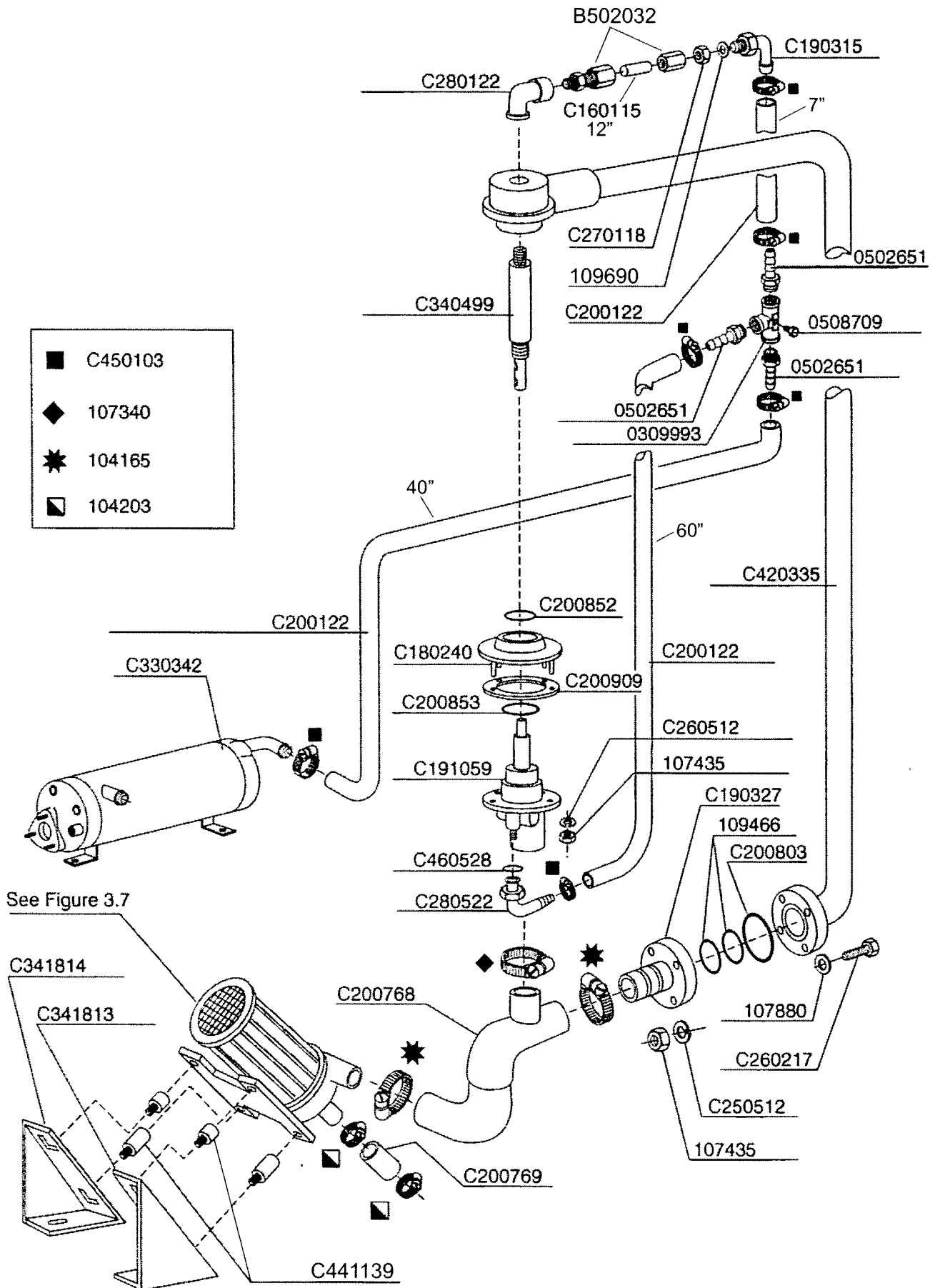

Figure 3.4- Wash and Rinse Piping

### WASH AND RINSE PIPING

Part No.	Part Description
C330342	TANK WELDED BOOSTER
C341814	SUPPORT WASH PUMP L-H
C341813	SUPPORT WASH PUMP R-H
C200769	HOSE PUMP SUCTION
C200768	HOSE PUMP DISCHARGE
C441139	BOLT, ABSORBING
C200122	HOSE BOOSTER DISCHARGE
107435	NUT, M6 HEX
C250512	WASHER LOCK -
C260217	SCREW, M6 X 25 FIL HD.
107880	WASHER, FLAT
C180413	T-PLASTIC FINAL RINSE
C340499	SPINDLE UPPER
C280122	ELBOW STAINLESS STEEL
B502032	CONNECTOR ASSY, 3/8 TUBE x 1/4 MPT
C160115	TUBING POLY RINSE
C270118	NUT BULKHEAD FITTING
109690	O - RING BULK HEAD FITTING
C190315	FITTING BULKHEAD
C420335	MANIFOLD VERTICLE WASH
C190327	CONNECTOR WASH MANIFOLD
109466	O - RING WASH MANIFOLD
C200803	O - RING WASH MANIFOLD
C200852	O - RING
C180240	SUPPORT LOWER HUB
C200909	GASKET LOWER SUPPORT HUB
C200853	O - RING
C191059	SPINDLE HUB ASSY. LOWER
C260512	WASHER LOCK
107435	NUT, M6
C460528	O - RING RINSE ELBOW
C280522	ELBOW HOSE BARB RINSE
0309993	FITTING, TEE TAPPED 1/8"
0508709	PLUG, 1/8"
0502651	FITTING. BARB

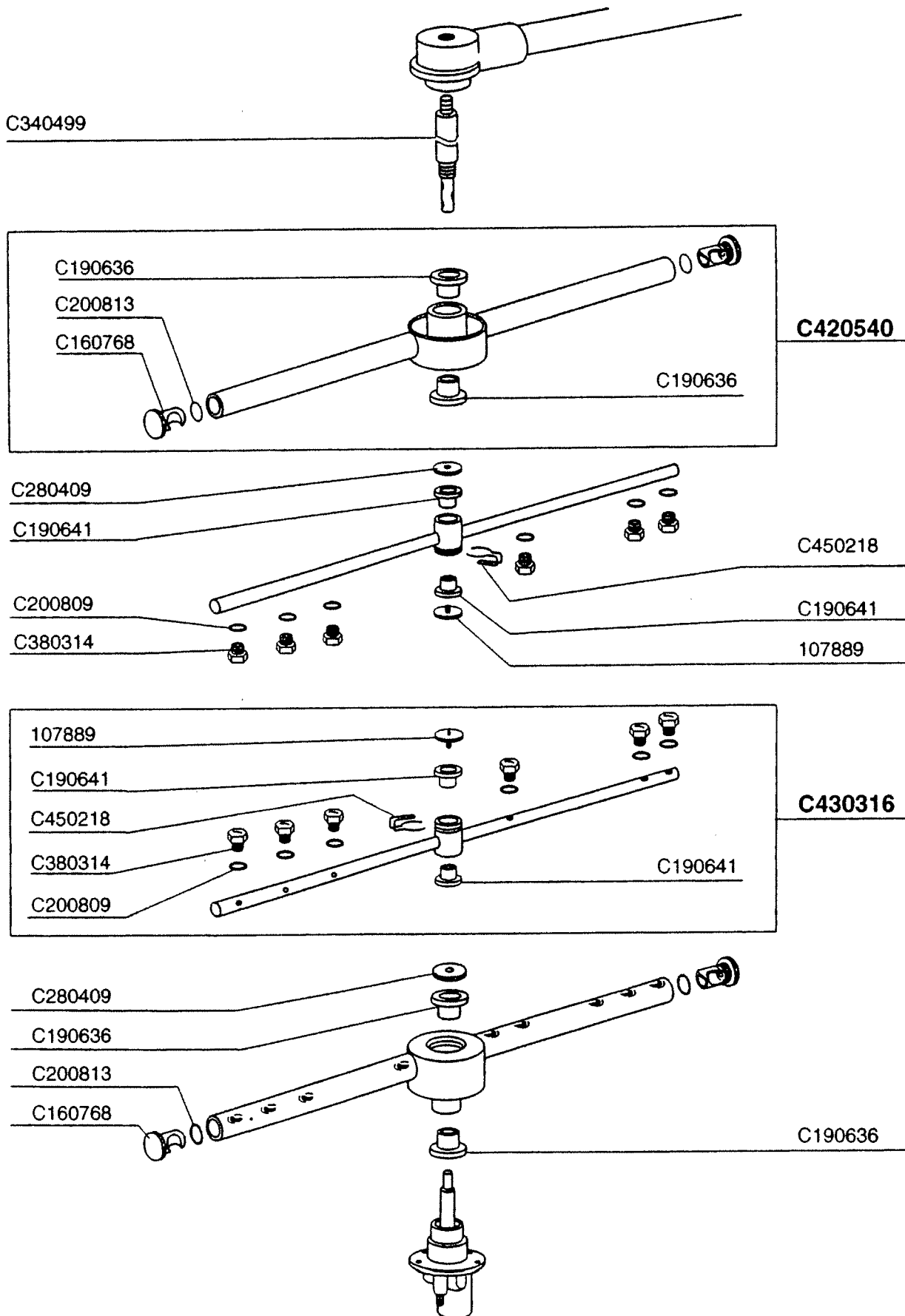

Figure 3.5- Wash and Rinse Spray Arms

---

**WASH AND RINSE SPRAY ARMS**

<b>Part No.</b>	<b>Part Description</b>
C340499	SPINDLE
C190636	BEARING WASH ARM
C160768	CAP END WASH ARM
C200813	O - RING END CAP
C280409	SPACER WASH ARM
C190641	BEARING RINSE ARM
107889	NUT RETAINER RINSE ARM
C450218	CLIP RETAINER NUT
C380314	NOZZLE RINSE ARM
C200809	O - RING RINSE NOZZLE
C420540	ARM WASH COMPLETE
C430316	ARM RINSE COMPLETE

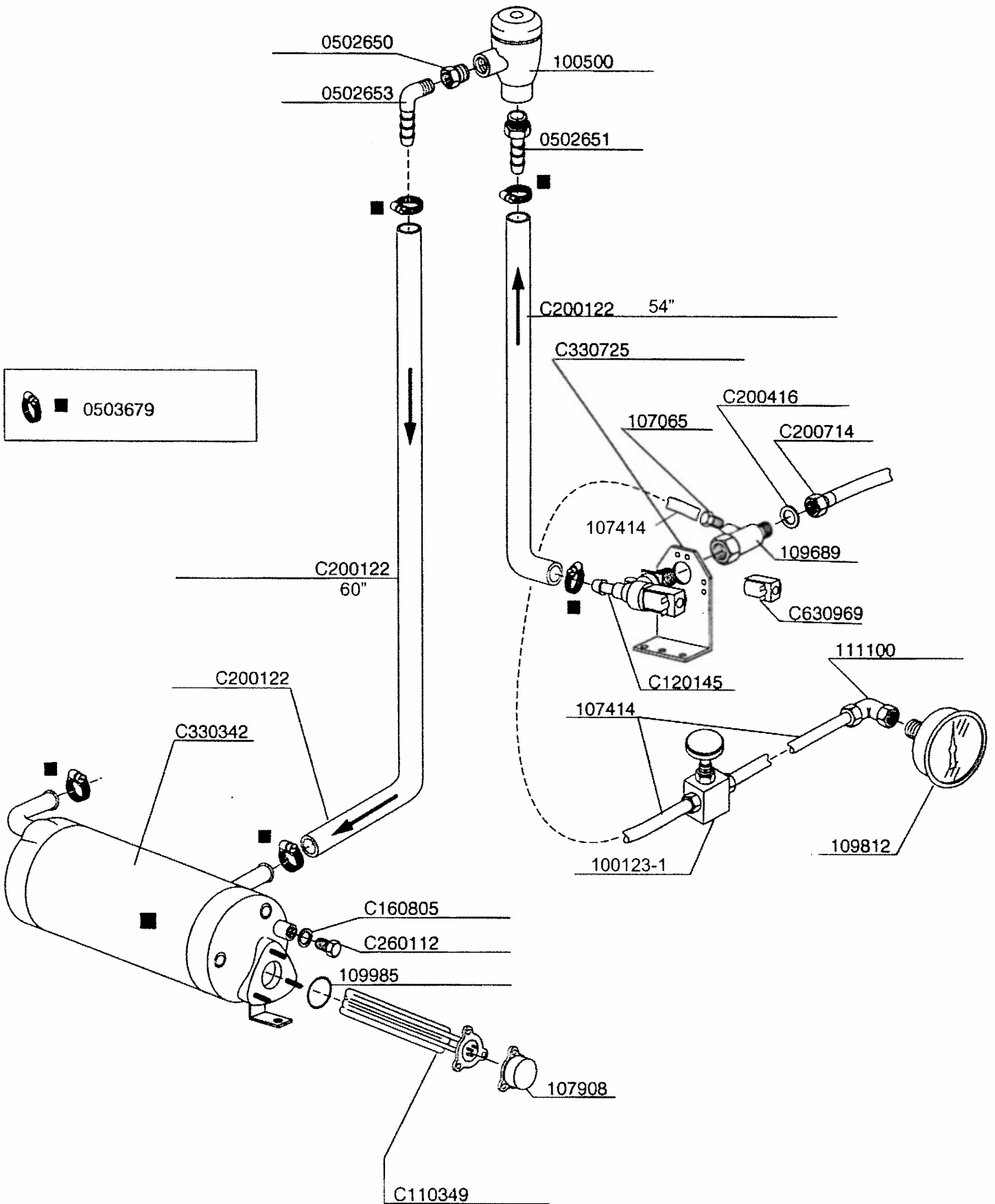

Figure 3.6- Water Inlet Piping

### WATER INLET PIPING

Part No.	Part Description
100500	VACUUM BREAKER, 1/2"
0508366	KIT, REPAIR 1/2" VACUUM BREAKER (NOT SHOWN)
C200122	HOSE
C630969	COIL SOLENOID VALVE
C120145	VALVE SOLENOID 240 VOLT
C330725	BRACKET MOUNTING SOLENOID
C200416	WASHER RUBBER FILL HOSE
C200714	HOSE FILL
107908	CAP BOOSTER PLASTIC
C260112	PLUG BOOSTER TANK
C160805	SEAL BOOSTER PLUG
109985	O - RING HEATER BOOSTER
C110349	ELEMENT HEATER 6 KW 208-240/3 (FOR 40°F/22°C RISE BOOSTER)
C110349	ELEMENT HEATER 6 KW 208-240/1 (FOR 40°F/22°C RISE BOOSTER)
C110362	ELEMENT HEATER 9 KW 208-240/3 (FOR 70°F/39°C RISE BOOSTER)
C110362	ELEMENT HEATER 9 KW 208-240/1 (FOR 70°F/39°C RISE BOOSTER)
C330342	TANK BOOSTER WELDED
107435	NUT, BOOSTER CAP, M6 S.S. HEX (NOT SHOWN)
0502653	BARB ELBOW 3/8 MPT X 1/2 HOSE
0502650	REDUCING BUSHING 1/2 X 3/8
0502651	BARB FITTING 1/2 MPT X 1/2 HOSE
109689	ADAPTER, TEE
100123 -1	COCK, GAUGE 1/4"
107065	CONNECTOR, 1/4 MPT X 1/4 TUBE
107414	TUBE, 1/4"
111100	ELBOW 1/8 NPT X 1/4 TUBE
109812	PRESSURE GAUGE

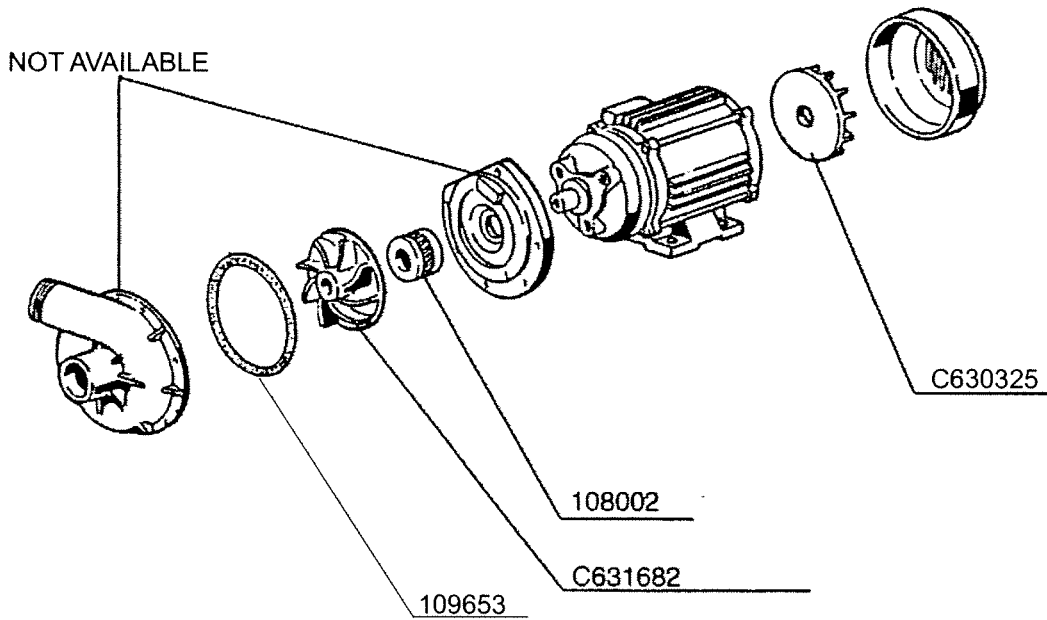
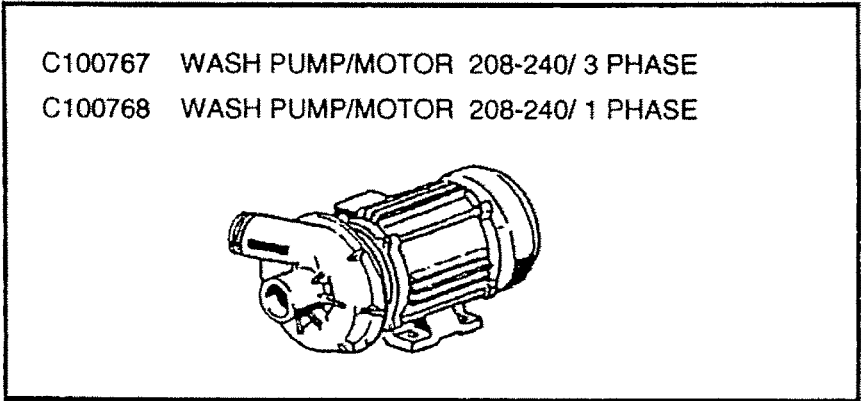

Figure 3.7- Pump/Motor Assembly



---

**PUMP/MOTOR ASSEMBLY**

<b>Part No.</b>	<b>Part Description</b>
C100767	PUMP WASH 220-240- 3 PHASE
C100768	PUMP WASH 220-240- 1 PHASE
108002	SEAL WASH PUMP
C631682	IMPELLER
C630325	FAN WASH PUMP MOTOR
C631202	START CAPACITOR, 1 PH (NOT SHOWN)

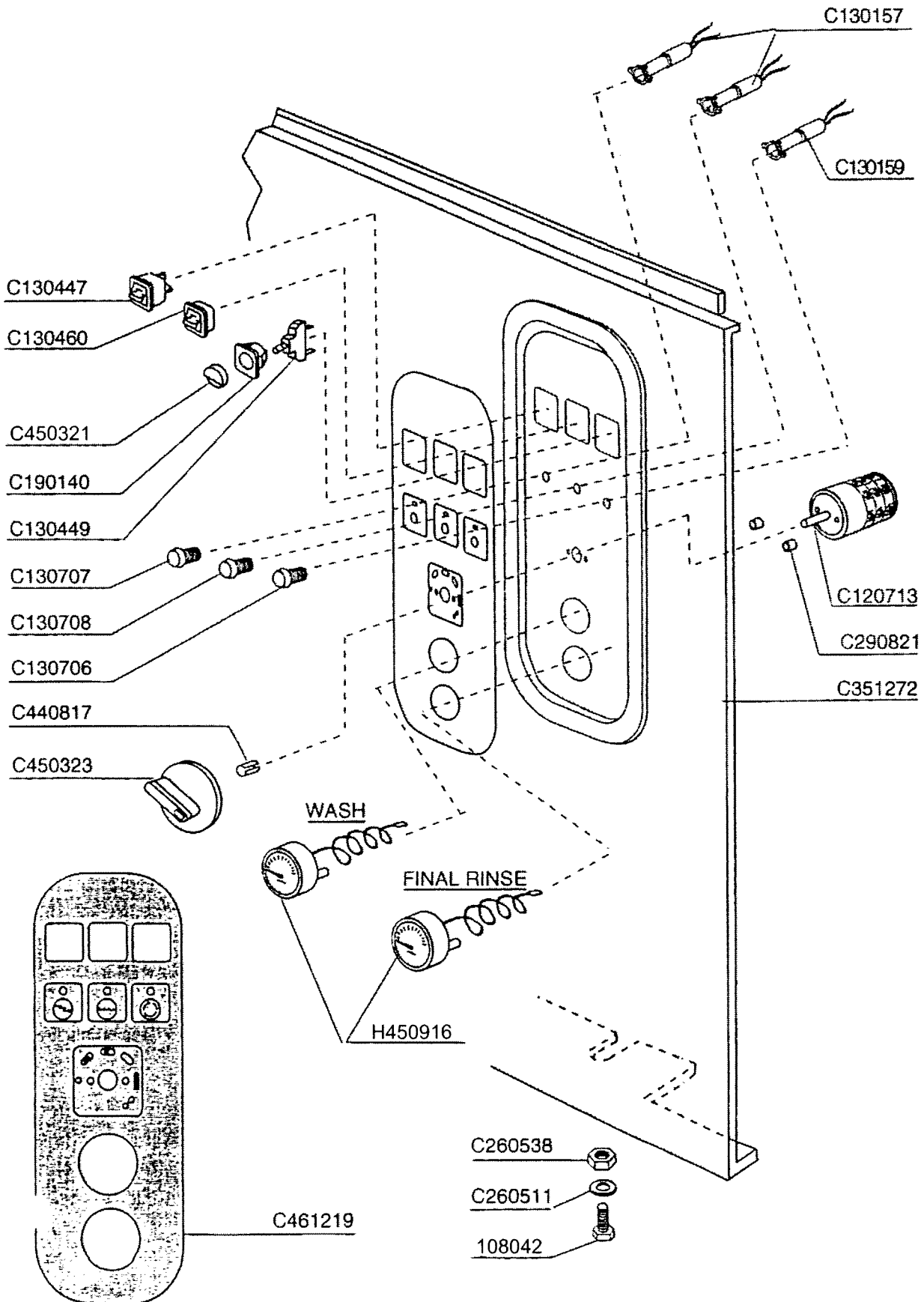

Figure 3.8- Control Panel

**CONTROL PANEL**

<b><u>Part No.</u></b>	<b><u>Part Description</u></b>
C130447	SWITCH, HOOD START/PUSHBUTTON START
C130460	SWITCH, EXTENDED WASH
C450321	BUTTON, SWITCH START
C190140	HOUSING, SWITCH START
C130449	CONTACTS, SWITCH START
C130707	LENS, CLEAR
C130708	LENS, GREEN
C130706	LENS
C450323	KNOB, SELECTOR
C440817	SLEEVE, SELECTOR KNOB
H450916	THERMOMETER
107444	OVERLAY, WASH THERMOMETER (NOT SHOWN)
107445	OVERLAY, FINAL RINSE THERMOMETER (NOT SHOWN)
108442	BOLT, M5 X 15
C260511	WASHER, FLAT
C260538	NUT, M5
C120713	SWITCH, SELECTOR
C290821	SPACER, SELECTOR SWITCH
C351272	PANEL, FRONT
C130159	LAMP, ORANGE
C130157	LAMP, GREEN

*Note: See pages 6-7 for control panel detail.*

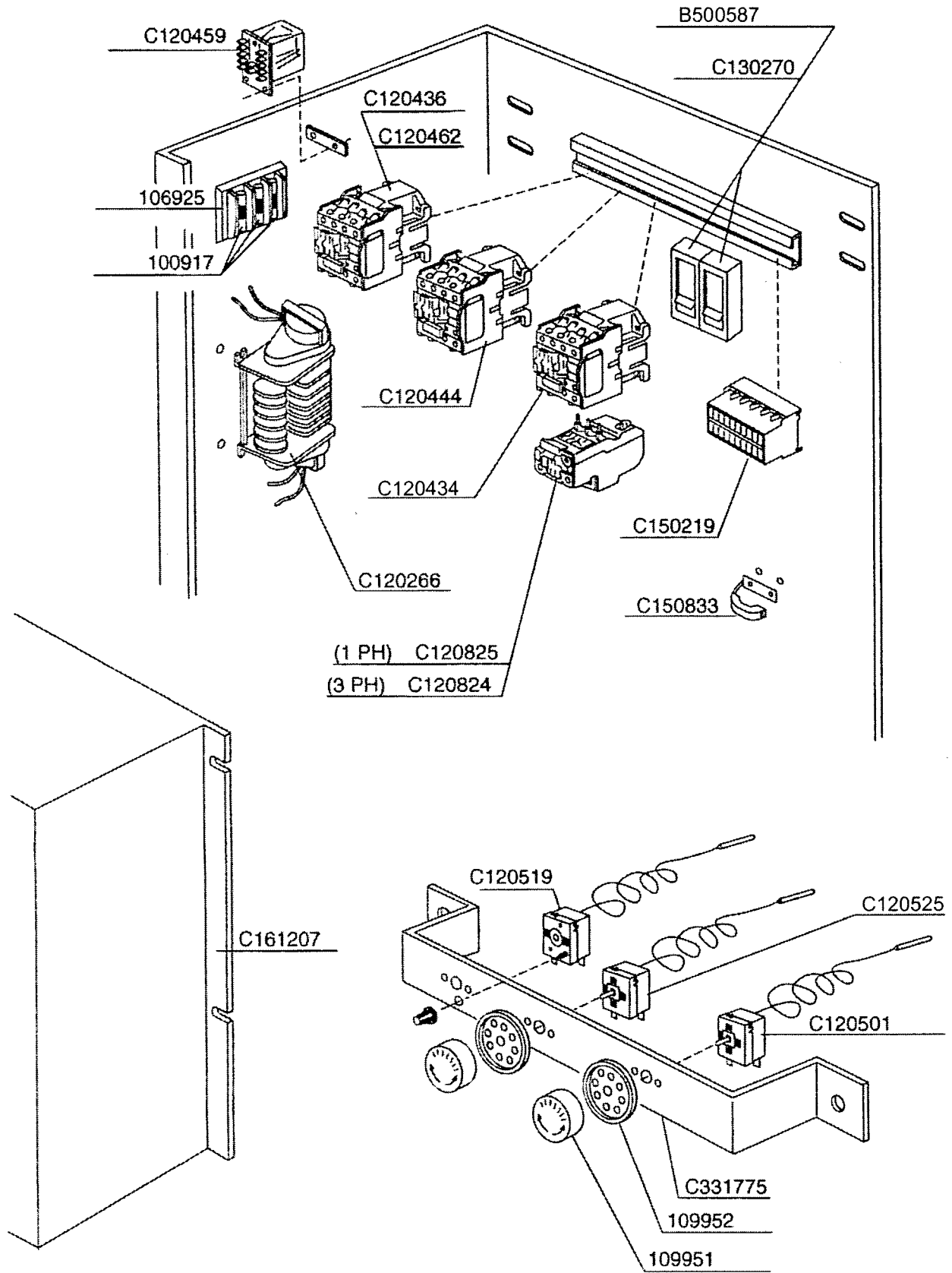
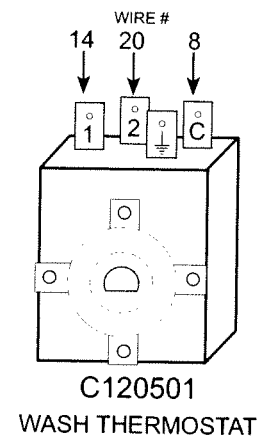
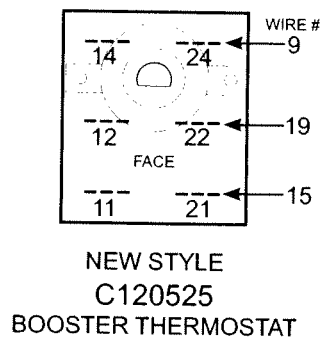
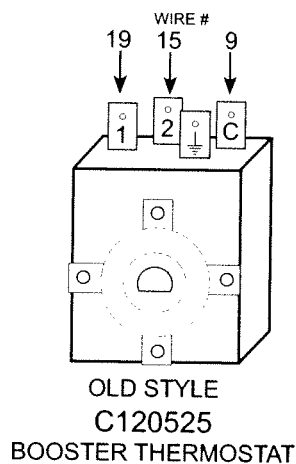

Figure 3.9- Control Cabinet

## CONTROL CABINET

Part No.	Part Description
C120459	RELAY CONTROL BOX
C120266	TIMER ASSEMBLY COMPLETE
C120434	CONTACTOR PUMP
C120444	CONTACTOR HEAT
C150219	BLOCK TERMINAL
C150833	CLAMP CABLE
109951	KNOB THERMOSTAT
C161207	COVER PLASTIC CONTROLS
C120519	THERMOSTAT SAFETY
C331775	BRACKET THERMOSTAT MOUNT
C120525	THERMOSTAT BOOSTER
C120501	THERMOSTAT WASH
109952	SPACER KNOB THERMOSTAT
106925	BLOCK, FUSE
100917	FUSE
C120436	CONTACTOR, BOOSTER 208V/60/1
C120462	CONTACTOR, BOOSTER 208V/60/3
B501587	HOLDER, FUSE
C130270	FUSE , 2 AMP
C120825	OVERLOAD 208-240V/60/1
C120824	OVERLOAD 208-240V/60/3



SYMBOL	DESCRIPTION
A1	MAIN SWITCH INTERRUPTEUR PRINCIPAL
A2	START SWITCH BOUNTON DE DEMARRAGE
A3	AUTOMATIC/MANUAL SWITCH SELECTEUR AUTOMATIQUE/MANUEL
B1	INDICATOR LAMP - MACHINE READY LAMPE TEMON MACHINE PRIETE
B2	INDICATOR LAMP - IN CYCLE LAMPE TEMON CYCLE EN COURS
B3	INDICATOR LAMP - IN CYCLE LAMPE TEMON CYCLE EN COURS
C1	PUMP CONTACTOR CONTACTEUR POMPE
C2	BOOSTER HEATER CONTACTOR CONTACTEUR RESISTANCE SURCHAUFFEUR
C3	TANK HEATER CONTACTOR CONTACTEUR RESISTANCE CUVE
C4	RELAY RELAIS
D1	TIMER MOTOR MOTEUR MINUTIERE
D2	SOLENOID VALVE ELECTROVANNE
E1	DOOR MICROSWITCH BARRI INTERRUPTEUR PORTE
F1	CAPACITOR CONDENSEUR
H1	JUNCTION BOUNTON
LL1	FUSES FUSIBLES
LL2	FUSES FUSIBLES
M1	PUMP POMPE
P1	PRESSURE SWITCH PRESIOSTAT
R2	BOOSTER HEATER RESISTANCE SURCHAUFFEUR
R3	TANK HEATER RESISTANCE ELEMENT CHAUFFANT CUVE
S1	WASH PUMP OVERLOAD RELAY THERMOQUE POUR POMPE DE LAVAGE
S2	EXTENDED WASH SWITCH INTERRUPTEUR DE LAVAGE PROLONGE
T2	BOOSTER THERMOSTAT THERMOSTAT SURCHAUFFEUR
T3	BOOSTER SAFETY THERMOSTAT THERMOSTAT SECURITE SURCHAUFFEUR
T3	TANK THERMOSTAT THERMOSTAT CUVE

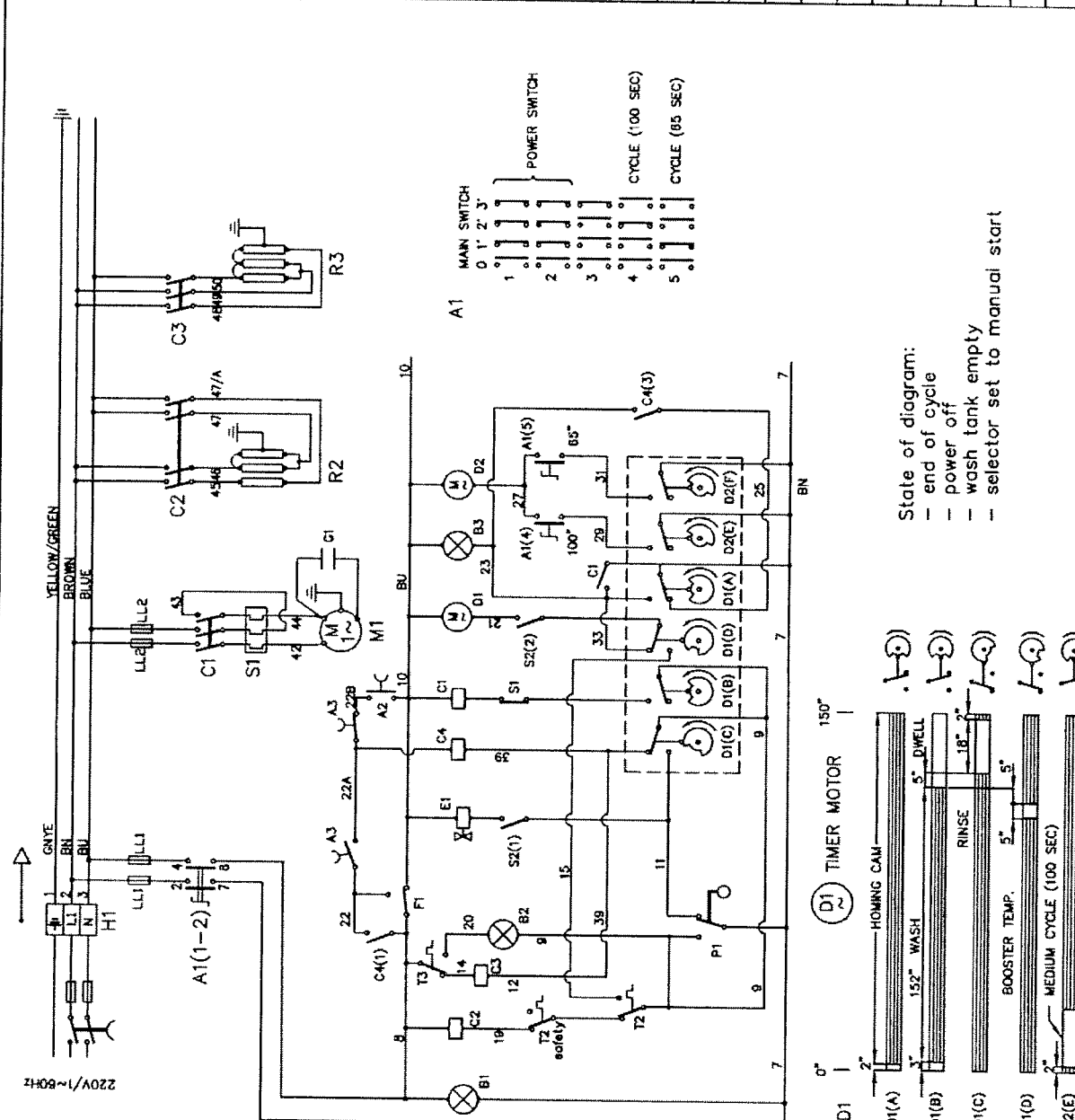

State of diagram:  
 - end of cycle  
 - power off  
 - wash tank empty  
 - selector set to manual start

Date 06/28/99	Schematic: MH65	1PH.
By O.Pastori		
Note Ref ELC00016		

**MOYER DIEBEL**  
 DWG. NO. 0509789

SYMBOL	DESCRIPTION
A1	MAIN SWITCH INTERRUPTEUR PRINCIPAL
A2	START SWITCH BOUTON DE DEMARRAGE
A3	AUTOMATIC/MANUAL SWITCH SELECTEUR AUTOMATIQUE/MANUEL
B1	INDICATOR LAMP - POWER ON LAMPE TENDON SOUS TENSION
B2	INDICATOR LAMP - MACHINE READY LAMPE TENDON MACHINE PRETE
B3	INDICATOR LAMP - IN CYCLE LAMPE TENDON CYCLE EN COURS
C1	PUMP CONTACTOR CONTACTEUR POMPE
C2	BOOSTER HEATER CONTACTOR CONTACTEUR RESISTANCE SURCHAUFFEUR
C3	TANK HEATER CONTACTOR CONTACTEUR RESISTANCE CUVE
C4	RELAY RELAIS
D1	TIMER MOTOR MOTEUR MINUTIERE
D2	SOLENOID VALVE ELECTROVANNE
E1	DOOR MICROSWITCH MICRO INTERRUPTEUR PORTE
F1	CAPACITOR CONDENSATEUR
H1	JUNCTION DOMMAGE
LL1	FUSES FUSIBLES
LL2	FUSES FUSIBLES
M1	PUMP POMPE
P1	PRESSURE SWITCH PRESSESTAT
R2	BOOSTER HEATER RESISTANCE SURCHAUFFEUR
R3	TANK HEATER RESISTANCE ELEMENT CHAUFFANT CUVE
S1	WASH PUMP OVERLOAD RELAY THERMOQUE POUR POMPE DE LAVAGE
T2	BOOSTER THERMOSTAT THERMOSTAT SURCHAUFFEUR
T3	BOOSTER SAFETY THERMOSTAT THERMOSTAT SECURITE SURCHAUFFEUR
T4	TANK THERMOSTAT THERMOSTAT CUVE

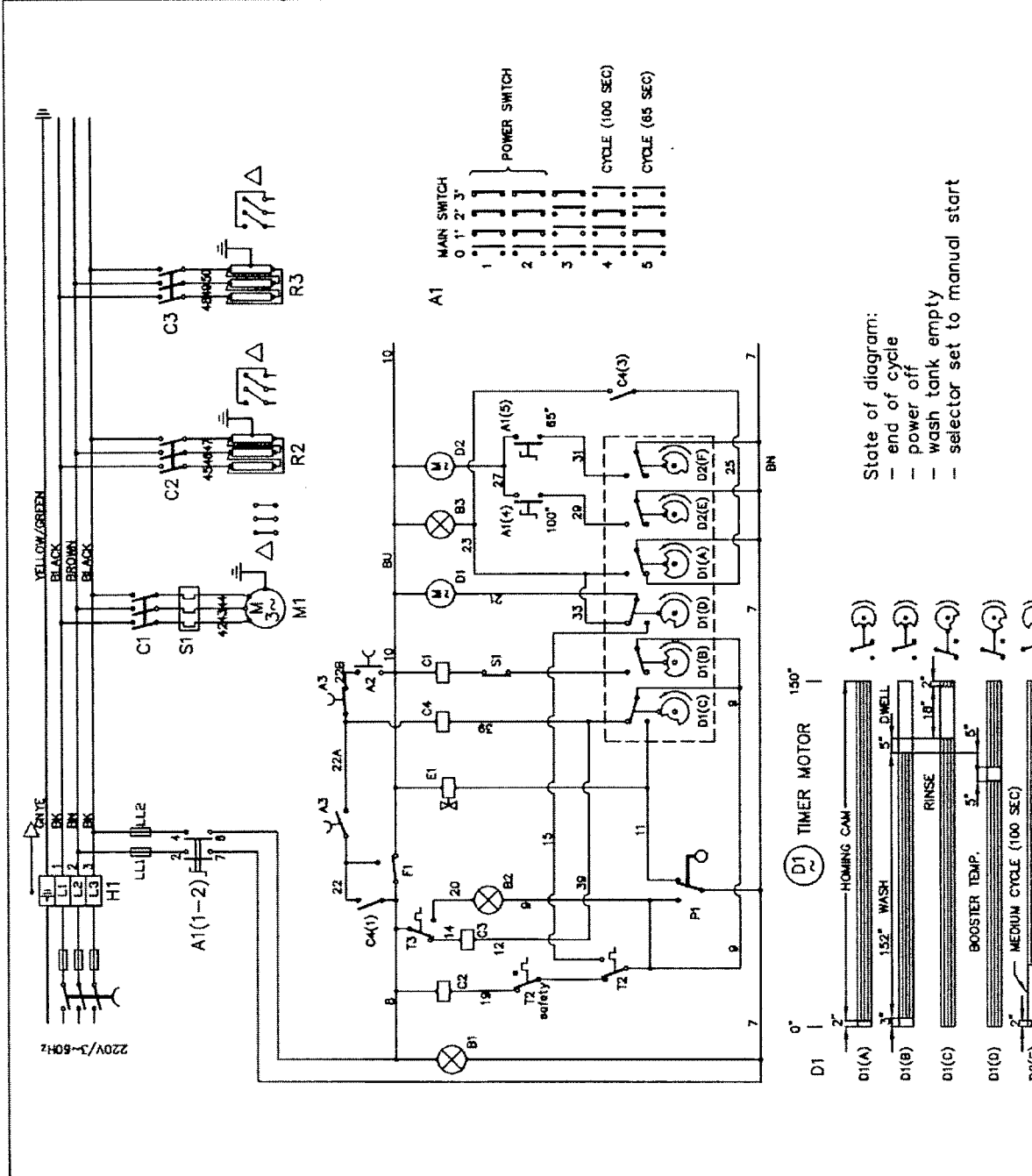

Date 26/01/99 Schematic: MH65 3PH  
 By O. Pastori  
 Note Ref ELC00015

